

## KM-4530



The KM-4530 and KM-5530 use a **mechanical counter** located behind the front door on the left hand side of the machine.

Your meter reading can be taken directly from this counter.

The copier can also produce a **Counter Report** providing information on the number pages printed and the average toner density.

**STEP 1** To locate the mechanical counter open the front door.

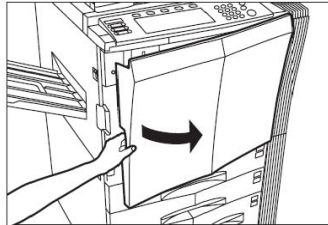

**STEP 2** Locate the mechanical meter in the upper left hand side of the machine.

Close the front door to return to normal operation.

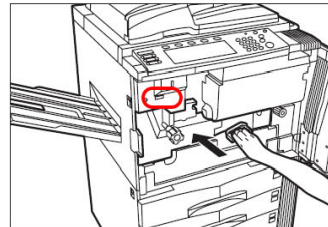

**STEP 3** To print the **Counter Report**, press the \* (Default Settings) button on the keypad (next to the Management Lock).

The Default Settings menu will appear on the Display.

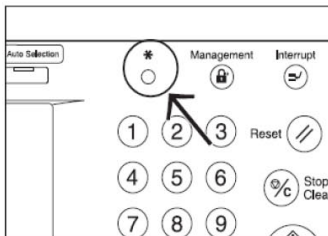

**STEP 4** Press the **Print Form** key on the touch panel.

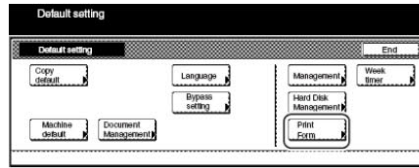

**STEP 5** Enter the Administrator Code.

"4500" for the KM-4530  
"5500" for the KM-5530

*NB: these are the default values but may have been changed by the Administrator / Key Operator.*

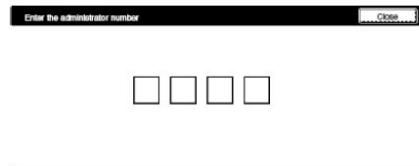

**STEP 6** Press the **Counter Report** key on the Print Report screen.

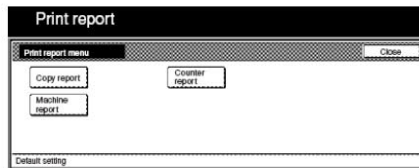

**STEP 7** The report will print out.

Press the **Close** key on the touch screen to return to the Default Settings screen (Step 4)

Press the **End** key on the touch screen to return to normal copy mode.

